

# GL10云台灯说明书

## GL10 Gimbal Searchlight

用户说明书 User Manual (V1.0)

2024.6.7

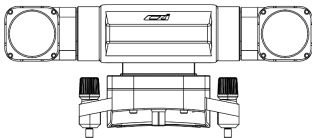



# 目录

一、免责声明与警告 .....	1
二、GL10云台探照灯介绍.....	2
三、GL10云台探照灯激活教程 .....	4
四、GL10云台探照灯使用教程 .....	11
五、GL10云台探照灯固件升级教程 .....	16
5.1 使用DJI Assistant 2 升级 .....	16
5.2 使用智声APP升级 .....	19

# Contents

I.Disclaimers and Warnings .....	24
II.Introduction to GL10 Gimbal Searchligh .....	26
III.Activation Tutorial for GL10 Gimbal Searchlight .....	29
IV.User Manual for GL10 Gimbal Searchlight.....	35
V.Firmware Upgrade Tutorial for GL10 Gimbal Searchlight.	40
5.1 Upgrade using DJI Assistant 2 .....	40
5.2 Upgrade in czi sound APP.....	43

---

## 一、免责声明与警告

感谢您购买成至智能产品。本文所提及的内容关系到您的安全以及合法权益与责任。使用本产品之前,请仔细阅读本文以确保已对产品进行正确的设置。不遵循和不按照本文的说明与警告来操作可能会给您和周围的人带来伤害,损坏本产品或其它周围的物品。本文档及所有相关的文档最终解释权归成至智能所有。如有更新,恕不另行通知。请访问 [www.czi.com.cn](http://www.czi.com.cn) 官方网站以获取最新的产品信息。

### 警告事项

GL10云台灯属于精密光学设备,如遇硬件问题,请返厂联系售后服务,切勿自行拆卸维修,否则将失去保修、维修资格。

### 注意事项

1.GL10云台探照灯,在无人机起飞前工作,功率默认限制在30%(功率可手动调节为50%或100%);起飞后,功率可达100%。

2.GL10云台探照灯,在工作后,请勿直接接触灯外壳,小心高温烫手。



## 二、GL10云台探照灯介绍

GL10云台探照灯,为成至首款最轻量级云台探照灯,适配 DJI Mavic 3 行业无人机,重量小于140g,额定功率20W。GL10云台探照灯,由光学成像透镜结构组成,发光角度为12.5°。连接 DJI Pilot 2 APP 即可控制开关、切换常亮及爆闪等模式,且能自动跟随云台相机的转动。GL10云台探照灯,具备先进的自动温控系统,工作1000小时后的光衰减小于5%。

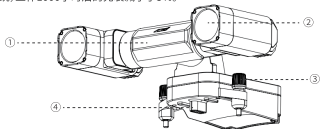

(1)GL10云台探照灯(前视)

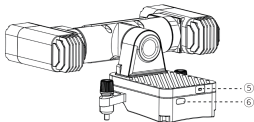

(2)GL10云台探照灯(后视)

①红蓝灯

②白光聚光灯

③ 防脱手拧螺丝

④ 供电通讯口

⑤复位按钮

⑥指示灯

## 技术参数

型号	GL10		
电气接口	DJI PSDK		
重量/g	<140		
尺寸/mm	L107*W128*H51.5		
总功率/W	30		
白光LED功率/W	20		
红蓝LED功率/W	2		
供电电压/V	15		
光通量/lm	1830±3%		
FOV /°	12.5		
探照距离/m	100	75	50
光斑直径/m	22.8	17.1	11.4
探照面积/m2	407	229	102
中心光照度/Lux	5.8	13.3	22.8
基本功能	白光夜间补光		
	红蓝爆闪		
	双轴云台增稳		
	云台AI算法自动调节		
云台可控转动范围	俯仰		-90°——+70°
工作温度	-20°C ~ +50°C		

## 三、GL10云台探照灯激活教程

### 3.1 使用智声App激活

3.1.1 打开智声App, 注册并登录账号。进入到主界面, 点击连接设备。



### 3.1.2 选择可用设备。

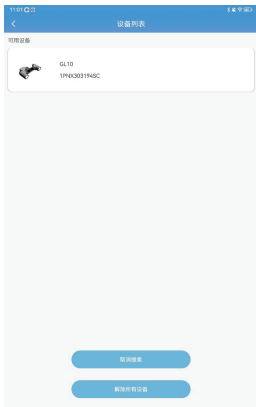

### 3.1.3 点击立即激活。



3.1.4 界面出现产品序列号 (如:1PNX) 以及激活时间 (如:2023-05-01), 表示设备已经激活成功。

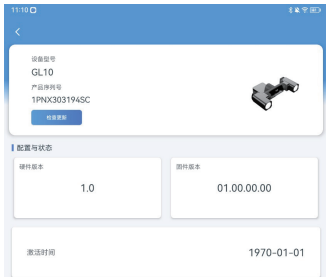

### 3.2 使用czi Pliot APP激活

3.2.1 GL10云台灯正确安装在无人机上,在遥控器上打开蓝牙设备,打开czi Pliot APP;搜索并连接GL10设备;点击激活。



### 3.2.2 激活须知弹窗,按指引步骤,点击同意。

无服务

设备激活

\*用户名

温晓烽

\*手机

18102596252

\*验证码

104516

重新发送40s

单位名称

czi

激活

#### 激活须知

1. GL10 附赠一年成至无忧服务（基础版），同意激活后，[成至无忧](#)同时生效。
2. 激活信息将作为您使用成至无忧的唯一凭证。  
更多信息，请查看[《服务条款》](#)。

☐ 本人承诺信息真实性，授权设备自动激活

同意

拒绝



### 3.2.3 激活成功。

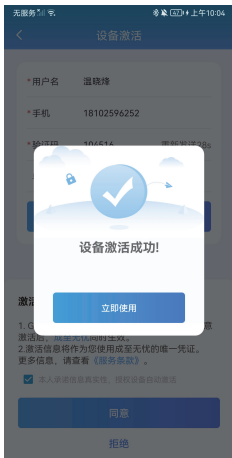

## 四、GL10云台探照灯使用教程

### 4.1 DJI Pilot 使用教程

4.1.1 在无人机上安装GL10,并拧紧手拧螺丝。

4.1.2 正确打开无人机电源(短按一秒长按三秒),启动无人机。

4.1.3 启动遥控器,打开APP。

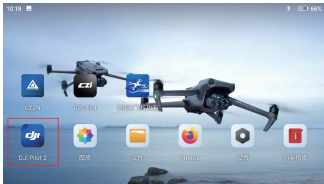

4.1.4 进入到主界面,显示GL10字样,说明负载连接成功。点击屏幕右下角进入飞行界面。

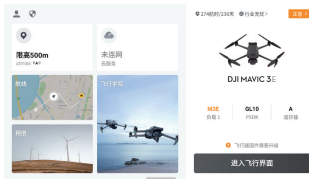

#### 4.1.5 点击PSDK按钮,显示GL10各控件按钮。



#### 4.1.6 GL10各控件按钮介绍。

	关灯		开灯
	爆闪关闭		爆闪开启
	警灯关闭		爆闪开启
	纯红警灯		纯蓝警灯
	亮度调节		亮度调节
	光斑自动居中 算法关闭		光斑自动居中 算法开启
	云台跟随		云台锁定

## 4.2 czi Pilot 使用教程

### 4.2.1 在无人机上安装GL10, 并拧紧手拧螺丝。在遥控器上打开czi Pilot APP

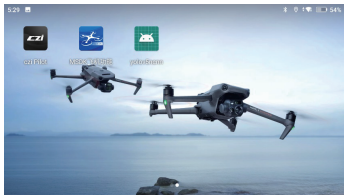

### 4.2.2 点击进入设备。



**GL10**

● DJI MAVIC\_3 ENTERPRISE

[进入设备>>](#)

#### 4.2.3 点击左上角GL10图标。



## 五、GL10云台探照灯固件升级教程

### 5.1 使用DJI Assistant 2 升级

5.1.1 GL10云台灯装好在无人机上, 无人机通电。打开PC端DJI Assistant 2, 使用无人机自带的Type-C线, 连接电脑和无人机。



5.1.2 连接成功后, 软件界面显示GL10, 点击GL10。



5.1.3 从官网上 [www.czi.com.cn](http://www.czi.com.cn) 下载最新固件到本地, 选择最新固件bin文件, 点击升级。



5.1.4 等待升级。

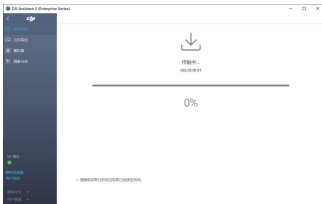



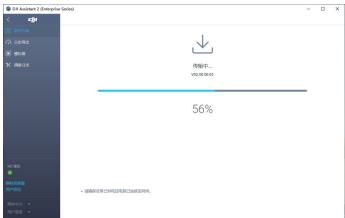

5.1.5 升级完成。

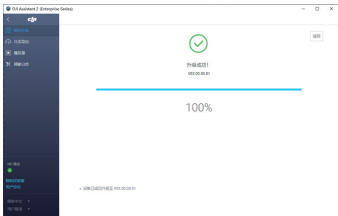

## 5.2 使用智声APP升级

### 5.2.1 进入到智声APP。



## 5.2.2 连接设备。

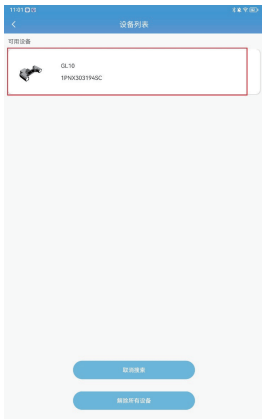

### 5.2.3 点击检查更新。



## 5.2.4 选择本地bin文件。



## 5.2.5 等待上传。



## 5.2.6 等待升级。



---

## I.Disclaimer and Warnings

Thank you for purchasing our intelligent product. The contents mentioned in this article are related to your safety and legitimate rights and responsibilities, so please read this article carefully to set up the product correctly before using. Harms of hurting you or the people around you or this product or other surrounding items may be caused as a result of failing to follow the instructions and warnings herein. The right for final interpretation of this article and all related documents is vested in CZI. Subject to update without notice. Please visit [www.czi.com.cn](http://www.czi.com.cn) for the latest product information.

### Warnings

The GL10 Gimbal Searchlight is a precision optical device. In case of any hardware issues, please contact our after-sales service for assistance. Do not attempt to disassemble or repair the device yourself, as it will void the warranty and service eligibility.

### Precautions

1.The GL10 Gimbal Searchlight operates at a default power limit of 30% before the drone takes off (the power can be manually adjusted to 50% or 100%). After takeoff, the power can be increased to 100%.

2.During the operation of the GL10 Gimbal Searchlight, please avoid direct contact with the outer shell of the light as it may cause burns by high temperature.

---

### **FCC Warning Statement**

Changes or modifications not expressly approved by the party responsible for compliance could void the user's authority to operate the equipment. This equipment has been tested and found to comply with the limits for a Class B digital device, pursuant to Part 15 of the FCC Rules. These limits are designed to provide reasonable protection against harmful interference in a residential installation. This equipment generates uses and can radiate radio frequency energy and, if not installed and used in accordance with the instructions, may cause harmful interference to radio communications. However, there is no guarantee that interference will not occur in a particular installation. If this equipment does cause harmful interference to radio or television reception, which can be determined by turning the equipment off and on, the user is encouraged to try to correct the interference by one or more of the following measures:

- - Reorient or relocate the receiving antenna.
- - Increase the separation between the equipment and receiver.
- - Connect the equipment into an outlet on a circuit different from that to which the receiver is connected.
- - Consult the dealer or an experienced radio/TV technician for help.

This device complies with part 15 of the FCC Rules. Operation is subject to the following two conditions:

(1) This device may not cause harmful interference, and (2) this device must accept any interference received, including interference that may cause undesired operation.

### **RF Exposure Statement**

To maintain compliance with FCC's RF Exposure guidelines, This equipment should be installed and operated with minimum distance of 20cm the radiator your body. This device and its antenna(s) must not be co-located or operation in conjunction with any other antenna or transmitter.



---

## **II.Introduction to GL10 Gimbal Searchlight**

The GL10 Gimbal Searchlight is the first lightest gimbal searchlight in the industry, designed specifically for the DJI Mavic 3 industrial drone, weighing less than 140g and with a rated power of 20W. The GL10 Gimbal Searchlight features an optical imaging lens structure with an emission angle of 12.5°. By connecting to the DJI Pilot 2 APP, you can control the power switch, switch between steady light and flashing modes, and the light will automatically follow the movement of the gimbal camera. The GL10 Gimbal Searchlight is equipped with an advanced automatic temperature control system, ensuring that the light attenuation is less than 5% after 1000 hours of operation.

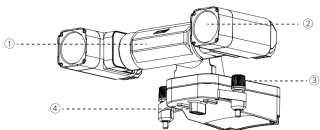

(1)GL10 Gimbal Searchlight (Front view)

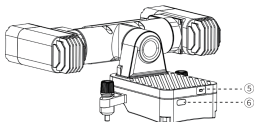

(2)GL10 Gimbal Searchlight (Rear view)

①Red and blue light

②White spotlight

③Anti-loose screw

④Power and communication port

⑤Reset button

⑥Indicator light

## Technical Parameter

Model	GL10		
Electrical interface	DJI PSDK		
Weight / g	<140		
Dimension / mm	L107*W128*H51.5		
Total power / W	30		
White LED power /W	20		
Red and blue LED power / W	2		
Supply voltage / V	15		
Luminous flux / lm	1830±3%		
FOV /°	12.5		
Illumination distance / m	100	75	50
Beam diameter / m	22.8	17.1	11.4
Illumination area / m2	407	229	102
Center illuminance / Lux	5.8	13.3	22.8
Basic functions	White light night illumination		
	Red and blue flashing		
	Dual-axis gimbal stabilization		
	Gimbal AI algorithm automatic adjustment		
Gimbal controllable rotation range	Pitch	-90°——+70°	
Operating temperature	-20℃ ~ +50℃		

### III.Activation Tutorial for GL10 Gimbal Searchlight

#### 3.1 Activate in the czi sound APP

3.1.1 Open the czi sound APP, register, and log in to your account. Enter the main interface and click on Connect Device.

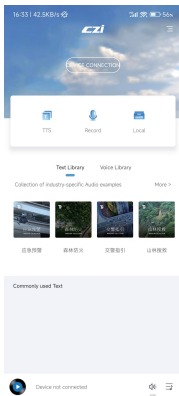

### 3.1.2 Select the Available device.

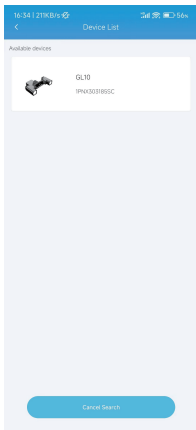

### 3.1.3 Click on Activate Now.

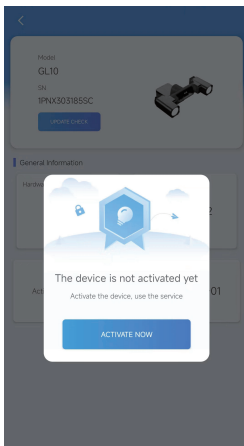

3.1.4 The interface displays the Product serial number (e.g., 1PNX) and Activation time (e.g., 2023-06-27), indicating that the device has been successfully activated.

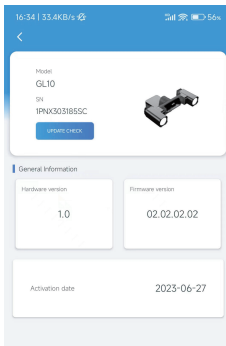

---

## 3.2 Activate in the czi Pilot app

3.2.1 Properly install the GL10 Gimbal Light on the drone. Enable Bluetooth on the remote controller and open the czi Pilot APP. Search for and connect to the GL10 device. Click on Activate.

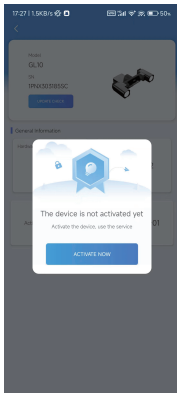



- 3.2.2 Activation notice popup. Follow the instructions and click Agree.
- 3.2.3 Successfully activated.

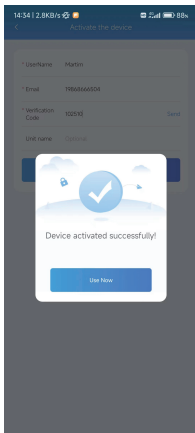

## IV. User Manual for GL10 Gimbal Searchlight

### 4.1 User Manual for DJI Pilot 2

4.1.1 Install the GL10 on the drone and tighten the screws securely.

4.1.2 Power on the drone correctly (short press for one second or long press for three seconds) to start the drone.

4.1.3 Turn on the remote controller and open the APP.

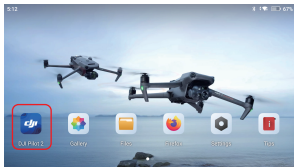

4.1.4 Enter the main interface, which displays the GL10 letters, indicating a successful connection to the load. Click on the bottom right corner of the screen to enter the flight interface.

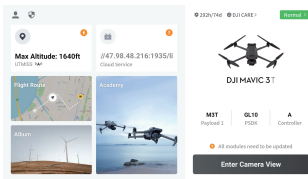

#### 4.1.5 Click the PSDK button to display the control buttons of GL10.



#### 4.1.6 Introduction to GL10 Gimbal Searchlight Control Buttons.

	Turn off the light		Turn on the light
	Turn off the flashing mode		Turn on the flashing mode
	Turn off the warning lights		Turn on the warning lights
	Activate red warning lights		Activate blue warning lights
	Adjust brightness		Adjust brightness
	Disable automatic beam centering algorithm		Enable automatic beam centering algorithm
	Enable gimbal follow mode		Lock the gimbal follow mode

## 4.2 czi Pilot User Tutorial

4.2.1 Install the GL10 on the drone and tighten the screws securely. Open the czi Pilot app on the remote controller.



4.2.2 Click on Enter the device.



**GL10**

● DJI MAVIC\_3 ENTERPRISE

[connect device >>](#)

#### 4.2.3 Click on the GL10 icon in the top-left corner.

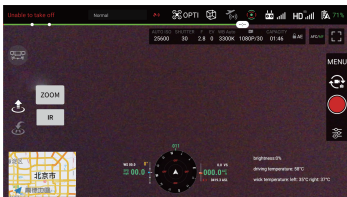

#### 4.2.4 Introduction to Icon Function Items.



## V. Firmware Upgrade Tutorial for GL10 Gimbal Searchlight

### 5.1 Upgrade using DJI Assistant 2

5.1.1 Install the GL10 Gimbal Searchlight on the drone and power on the drone. Open DJI Assistant 2 on your PC and use the Type-C cable provided with the drone to connect the computer and the drone.



5.1.2 After successful connection, the software interface will display GL10, Click on GL10.

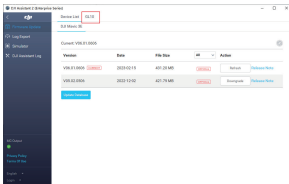

5.1.3 Download the latest firmware from the official website [www.czi.com.cn](http://www.czi.com.cn) to your local device. Select the latest firmware bin file and click on Upgrade.

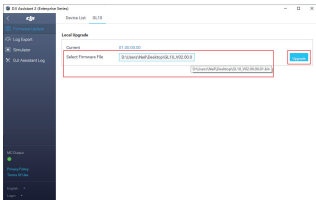

5.1.4 Waiting for upgrade.

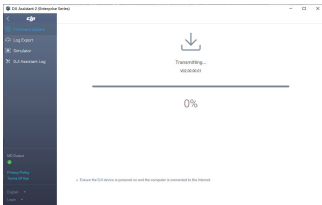



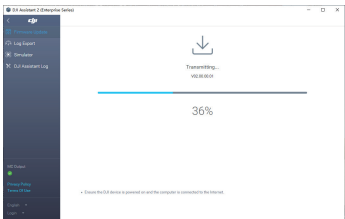

### 5.1.5 Upgrade completed.

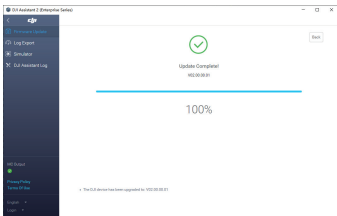

## 5.2 Upgrade in czi sound APP.

### 5.2.1 Enter the czi sound APP.

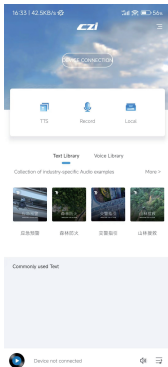

## 5.2.2 Connect the devices.

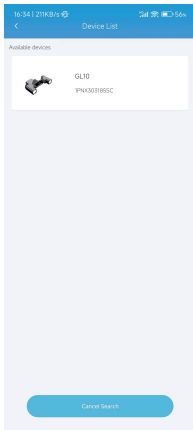

### 5.2.3 Click on Check for upgrade.

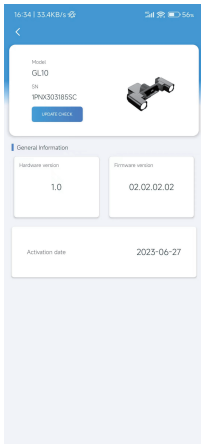

## 5.2.4 Select local bin file.



## 5.2.5 Waiting for upload.

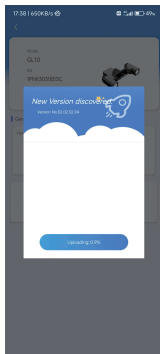

## 5.2.6 Waiting for upgrade.

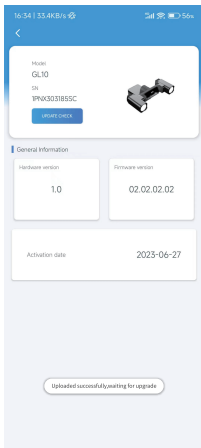



成至 技术支持

[www.czi.com.cn](http://www.czi.com.cn)

服务热线：400-008-8306

如您对说明书有任何疑问或者建议

请通过以下电子邮箱联系我们：

[czzn@czi.com.cn](mailto:czzn@czi.com.cn)

ChengZhi Support

[www.czi.com.cn](http://www.czi.com.cn)

Service hotline: 400-008-8306

If you have any questions or suggestions  
about the instructions, Please contact us  
through the following email address:

[czzn@czi.com.cn](mailto:czzn@czi.com.cn)

Made in China